

ITEM: 24 Cale chassis 1

Qty: 1 Babord + 2 Tribord - Total 3 1

Material: S235JR

Protection: Primer

Weight: 1.29 kg

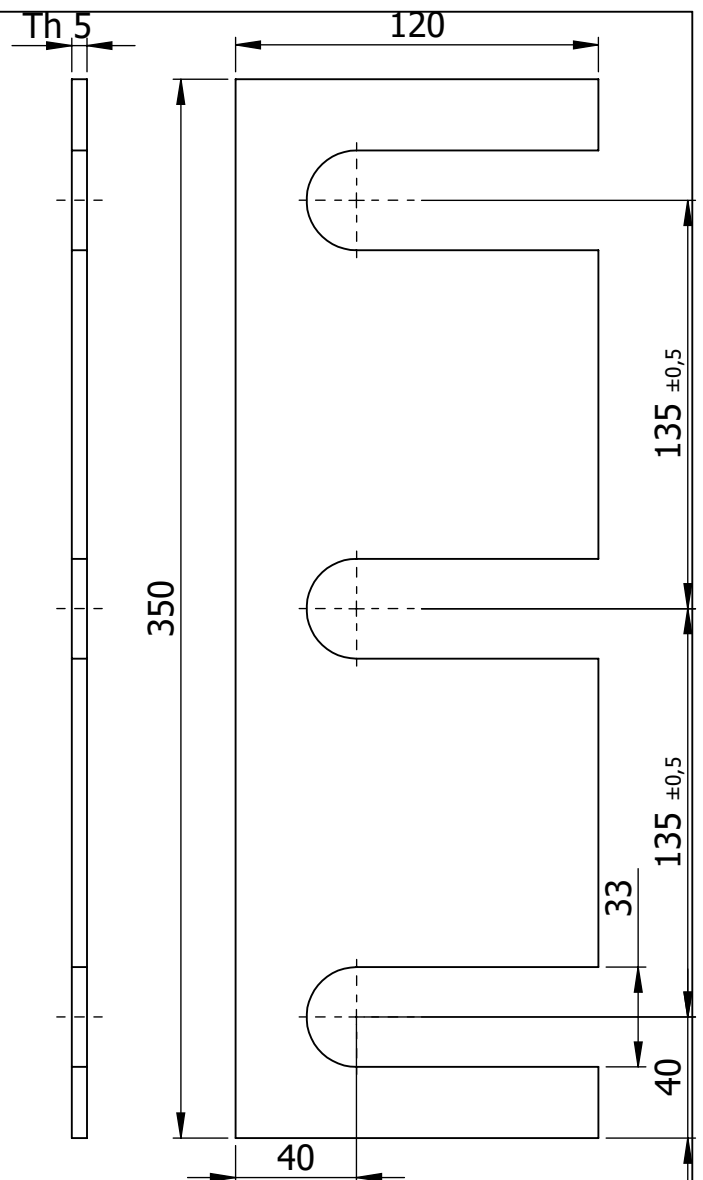

NOTA:

* General tolerances without specific indication: ISO 2768 mK

* General roughness unless otherwise indicated: Ra 12,5 (Gross)

* Grind down the edges that are not machined with R:1 to R:2

1	08/07/2025	Modif. Thk 15 -> 5 - Qty 2 Portside - Qty 4 Starboard cf DWG N° 865 F 0000	DCO	GPL	OPO
0	29/08/2024	For construction	GPL	DCO	JLS
A	12/07/2024	First issue	GPL	-	-
REV.	DATE	MODIFICATION	AUTHOR	CHECKED	APPROVED



Immeuble Le Concorde
4, rue Jacques Daguerre
92500 RUEIL-MALMAISON (F)
TEL: +33 (0) 1.41.39.86.70
www.kleyfrance.fr

PROJECT

57-IFR-23

Treuil Grand Fond N/O Pourquoi Pas ?

TITLE

ANNULAR TRACTION WINCH (ATW)

Cale chassis 1

SCALE

2:5

SIZE

A4

NUMBER

854 M 5024

CUSTOMER REF:

Jouvence du N/O « Pourquoi Pas »

SHEET 1 OF 1

" NOTICE : Information herein presented is confidential, proprietary information of KLEY-FRANCE. Any person accepting this information is required to accept the same in confidence, to agree to make no disclosure, use, or duplication thereof except as authorized by K-F and to return the same on request"